



ninoSAFE

Superior
Operator and Product
Protection

Biological Safety Cabinets EN 12469, NSF/ANSI 49

Superior operator and product protection

Nino Labinterior manufactures intelligent engineered biological safety cabinets that provide clean air solutions for a wide range of applications, ranging from routine work with potentially hazardous samples to handling cytotoxic compounds. ninoSAFE provides the level of operator, product and environmental protection you need and every cabinet is designed to make working safely as easy and as comfortable as possible.

Engineered by Experience - Compact design but still best usable inner dimensions.

ninoSAFE biological safety cabinets have been tested and validated at customers since 2015 reassuring their performance, reliability, quality and ease of use. The latest technology in combination with State-of-the art technique ninoSAFE offers advanced products yet easy to clean and simple to maintain. Scandinavian design brings ergonomics to a higher level. Dimmable LED light comes as standard feature together with remarkably low sound levels. Support stands are available in either manually or electrically adjustable, all in clean room design.

Nino Labinterior's motto is "Special is our standard" meaning that all our products can be custom made and configured to meet every specific requirement within reasonable time and budget.

We work closely with our customers to create and support biological safety cabinets that offer unmatched quality, precision and reliability with highest level of cleanability.



Engineered by Experience

Worldwide remote support
 ninoSAFE biological safety cabinets can be order with a unique remote support offering unmatched user support, trouble shooting, adjustments and update service. Furthermore the system allows up to 12 months of continuous data backup. With customer approval we access the cabinet remotely wherever it is installed, requiring only open internet access. High security and without managing firewalls.

Noise
 Field case studies prove that ninoSAFE biological safety cabinets measure <47 dB(A) when operating at 0,5 m/s inflow and 0,35 m/s down flow. By applying the latest filter and fan technology into our products we know what can be achieved.

Weighing
 A wide range of weighing accessories are available. Since ninoSAFE is close to vibration free it offers weighing inside at 4 decimals without additional support stand.

Standard Features
 All ninoSAFE biological safety cabinets come with dimmable LED lighting. Adjustable or electrical elevation support stands at your choice operated directly from the OP touch panel. UV-light is positioned with easy access and available in either fluorescent standard tube or LED offering incomparable long life. ninoSAFE is designed to be comfortable and ergonomically without arm rests thanks to intelligent designed v shaped table tops allowing operator to work comfortably without obstructing the air vents.

"Special is our Standard"

Technical specifications ninoSAFE BSC						
Type		nS600	nS900	nS1200	ns1500	nS1800
Dimensions						
External dimensions, WxDxH	mm	600x730x1953(1978)	1003x799x1953(1978)	1303x799x1953(1978)	1603x799x1953(1978)	1907x799x1953(1978)
Internal dimensions, WxDxH	mm	560(590)x520(625)x700	900x520(625)x700	1200x520(625)x700	1500x520(625)x700	1800x520(625)x700
Front window opening	mm	200 (adjustable 180 - 330)				
Work height, standard support stand	mm	700 - 1050				
Minimum door way	mm	730	800	800	800	800
Weight						
Equipment	kg	145	190	220	250	280
Air velocity						
Vertical flow	m/s	0.28 (adjustable 0.25 - 0.53)				
Inflow	m/s	0.45 (adjustable 0.45 - 0.55)				
Deviation	±%	<8	<8	<8	<8	<8
Noise						
Noise level ISO3744	dB(A)	44	46	46	47	47
Ventilation						
Down flow rate	m3/h	340	510	680	840	1 010
Exhaust flow rate	m3/h	180	290	390	480	580
Filter technology						
Main/Exhaust	Type	HEPA H14 EN1822, 99,999% at 0,3 µm particle size				
Light						
LED	Lux	0-2000, dimmable				
Electrical data						
Voltage frequency	V/Hz	220-240/50-60 or 110-120/50-60				
Power consumption, from	W	60	90	100	130	140

Our models are built and tested according to national and international standards including: EN 12469, NSF/ANSI 49, EN 61010-1

Made in Scandinavia – ISO9001:2015 and ISO14001:2015

Superior
 Lab
 Solutions

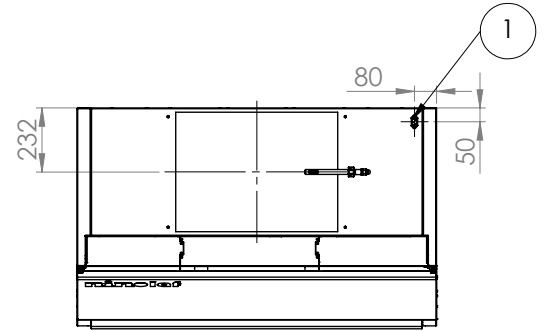
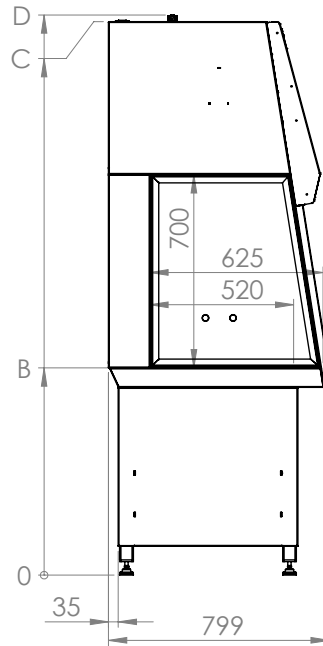
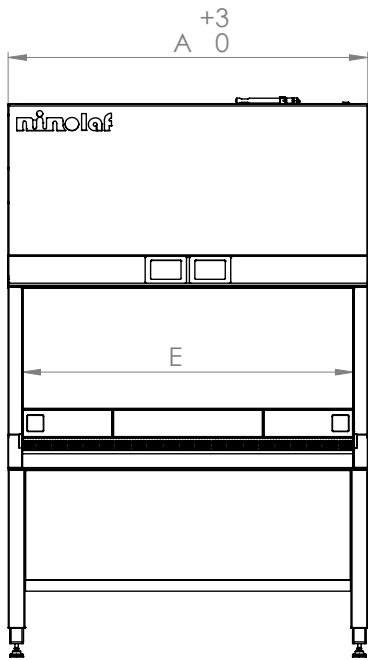

nino SAFE specifications

Cabinet	A - Length	B - Work height	C - Top cabinet	D - Highest point	E - Work opening	W - Weight
nino SAFE 900	1003 mm	700-950 mm	1953-2203 mm	1978-2228 mm	900 mm	190 Kilo
nino SAFE 1200	1303 mm	700-950 mm	1953-2203 mm	1978-2228 mm	1200 mm	220 kilo
nino SAFE 1500	1603 mm	700-950 mm	1953-2203 mm	1978-2228 mm	1500 mm	250 kilo
nino SAFE 1800	1907 mm	700-950 mm	1953-2203 mm	1978-2228 mm	1804 mm	280 kilo

Notes	
POS.	Description
1	Power supply point



Separate control and status/alarm display for clear information



Easy-to-use intuitive user interface with touchscreen



Easy-to-clean electrical outlets and optional USB- and RJ45 outlets



Clean room design adjustable support stand

ninoSAFE - A complete range also available in following models:

ninoSAFE plus (EN12469, DIN12980)
 ninoSAFE B2
 ninoSAFE XL (EN12469)
 ninoSAFE XL plus (EN12469, DIN12980)

ninoSAFE sterile (Clean bench)
 ninoSAFE class I (EN12469)
 ninoSAFE horizontal